

Specifications

Electrical Performance:

- 1. Rated Voltage: 125V AC RMS.
- 2. Rated Current: 1.5 AMP.
- 3. Contact Resistance: 30mΩ Max.
- 4. Insulation Resistance: 500MΩ Min. @500V DC
- 5. Withstand Voltage: 1000V (AC 50Hz RMS) per Minute

Environment Test:

- 1. Operating Temperature: -40°C - +85°C
- 2. Operating Humidity: 90~95% (40±2°C)

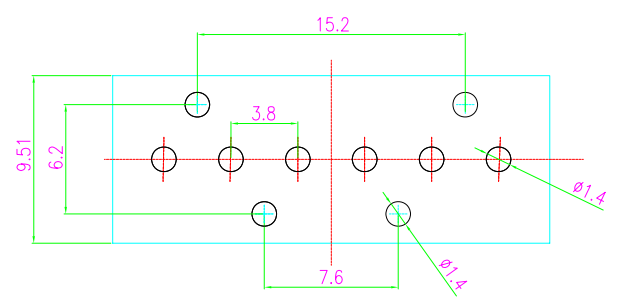
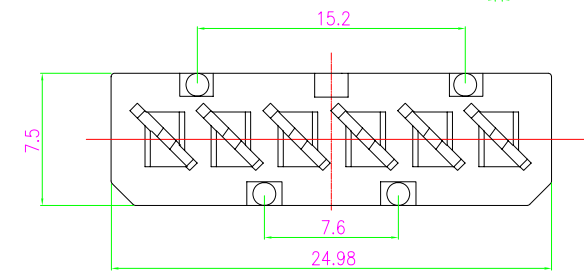
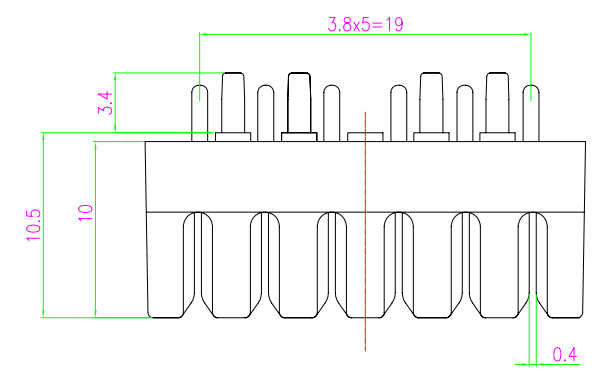
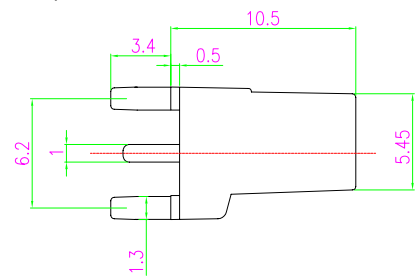

P.C.B. LAYOUT

Tolerance: ±0.05

Mechanical Performance:

- 1. Base Material: PC
- 2. Terminal Material: Phosphor Bronze T=0.50mm
- 3. Plating: Tin Plating
- 4. Test Life: ≥ 750 cycles
- 5. PCB Weld Retention: Mix. 1LB

KLS ELECTRONIC CO., LTD.

INTENDED USED PART NAME:		DRAWING BY 叶成飞 20150227		UNLESS OTHERWISE SPECIFIED TOLERANCES ARE X. ±0.3 .X ±0.2 .XX ±0.15 ANG. ±1°						
INTENDED USED PART NO.:		CHECKED BY 向四海 20150227								
DRAWING NO: IDC-6P6C		APPROVED BY 王晓明 20150227								
SCALE	NONE	REV.	B	UNIT mm	△ A	NEW RELEASE	XSH	20150227		
					NO. REV.	REVISIONS	CHK.	DATE		