

REV.	ECN NO.	DATE	SIGN	DESCRIPTION

F  
E  
D  
C  
B  
A

THIS DOCUMENT IS SUBJECT TO CHANGE WITHOUT NOTICE. IT IS CONFIDENTIAL AND A PROPERTY OF Amphenol LTW. DISCLOSURE TO THIRD PARTY HAS TO BE AUTHORIZED BY Amphenol LTW.

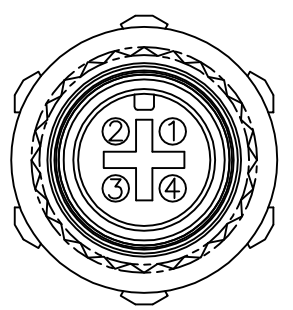
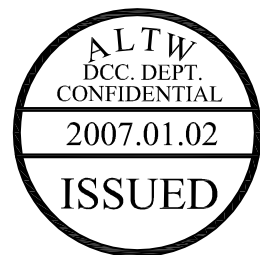
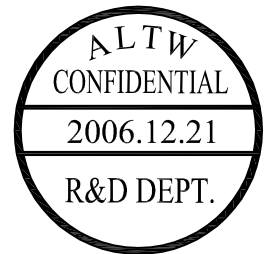
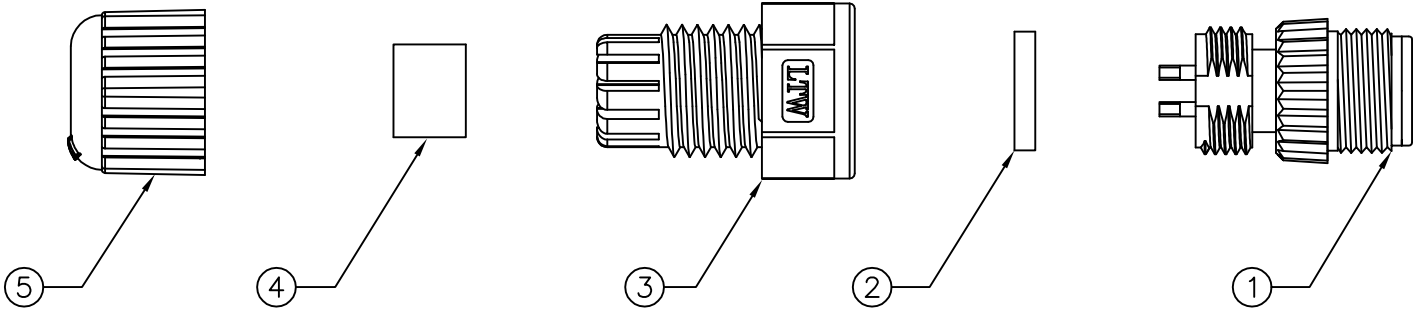

Pin Assignments  
Front View

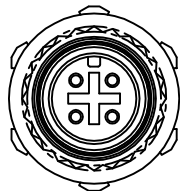
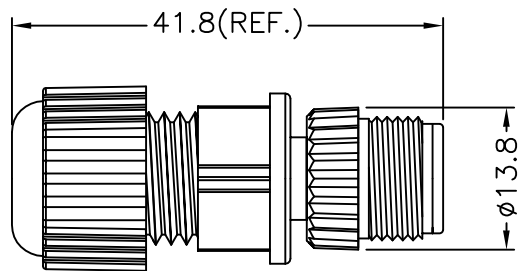

Conn.

- Note:
- \* @C Important Dimension To Check.
  - \* Waterproof Rate: IP68
  - \* Housing: Black, Nylon+GF
  - \* Pin: Copper Alloy, Gold Plated
  - \* Nut: Black, Nylon+GF
  - \* Gasket: Black, EPDM
  - \* Clamp Ring: Black, Nylon
  - \* Sealing Nut: Black, Nylon
  - \* Seal: Black, EPDM
  - \* Seal For Cable OD:  $\phi 4.5\text{mm} \sim \phi 6.5\text{mm}$

UNIT:mm 	TITLE M12 Conn Assy Screw 4Pin M Conn M Pin		<b>Amphenol LTW</b> 安費諾亮泰企業股份有限公司	ITEM NO 12P-04BMMA-SL8001	DRAWN BY Jason Manas	DATE 2006/12/21
	TOLERANCE $\pm 0.5$ mm	SCALE Free		SHEET 1 OF 1	DWG NO 12P-04BMMA-SL8001	CHECKED BY Alan MJ Sundo
REV. A	SIZE A4	@C :Inspection Item		CUSTOMER ALTW	APPROVED BY Max Hung	DATE 2006/12/21